

ELEVATION VIEWED FROM INSIDE

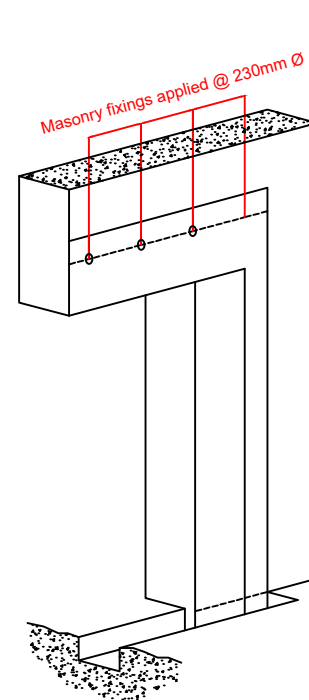

R.C. LINTEL

SUITABLE MASONRY FIXINGS ABLE TO WITHSTAND LOAD TO BE USED

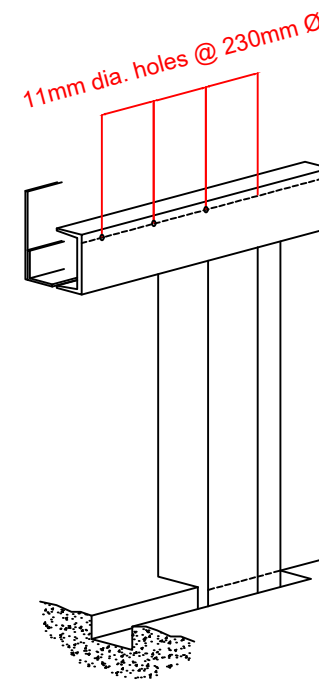

R.S. CHANNEL LINTEL

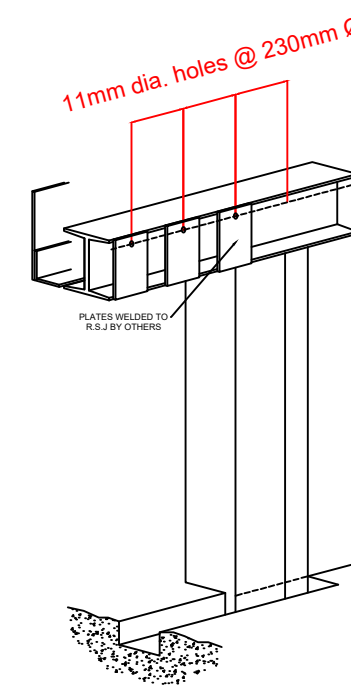

R.S. JOIST LINTEL

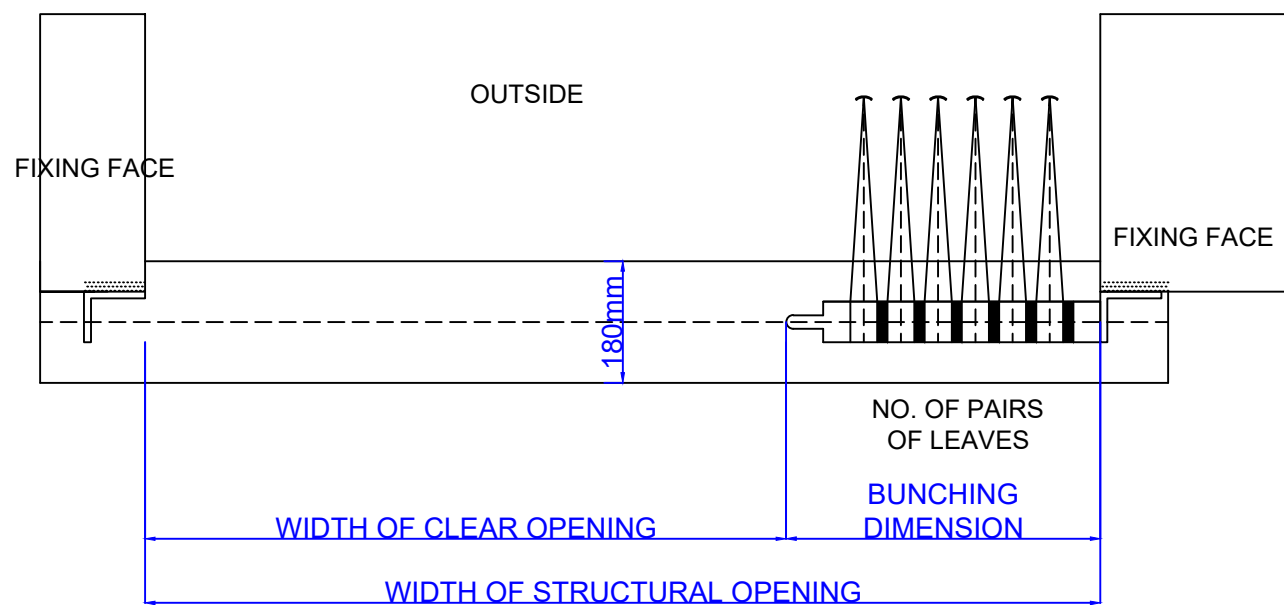
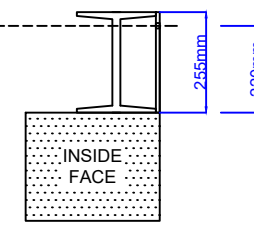
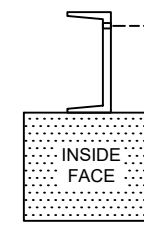

PLAN VIEW

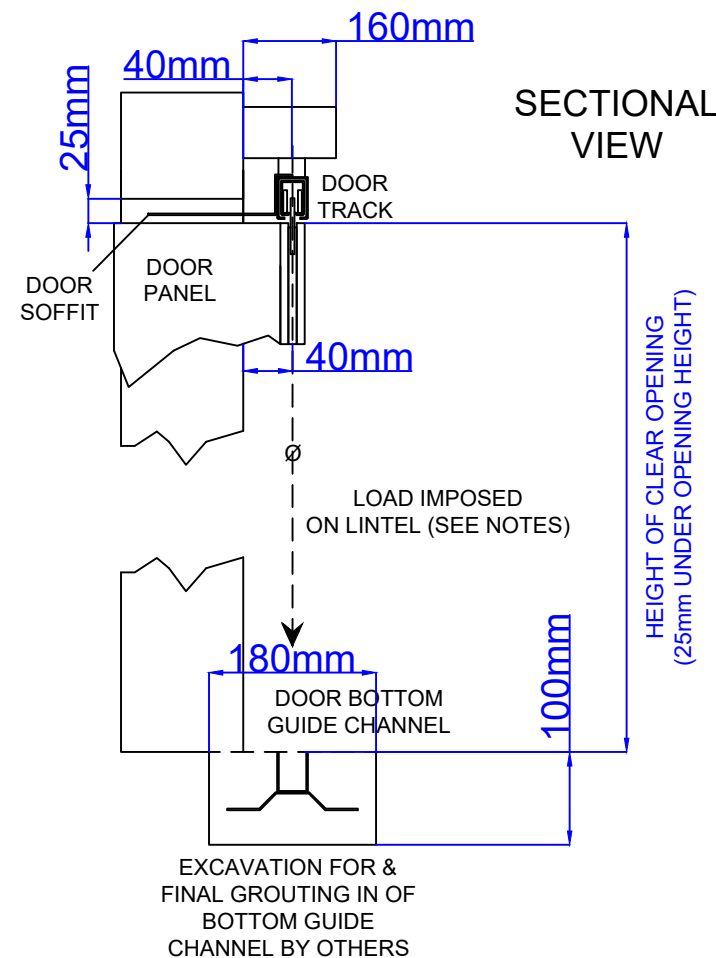

SECTIONAL VIEW

**W ESSEX INDUSTRIAL DOORS**  
(YEOVIL) LTD

**WID SLIDING SHUTTER TYPE HG ARRANGEMENT 3 RIGHT HAND, MANUALLY OPERATED**

WID-HGR003

Location:		Architect/Contractor:	
Order no.:		Scale: <b>NTS</b>	
Drawn By: <b>TIW</b>	Checked By:	Approved By:	
Date: 20/02/2023			

TOTAL NUMBER OF EQUAL SPACES FOR BOLT FIXINGS RELATED TO DIMENSION (W)

	1350	1940	2530	3120	3710	4300	4890	5480	6075	6665	7255	7845
(H)	1	2	3	3	4	5	5	6	6	8	8	9
	1	1	2	3	3	4	5	6	6	7	7	8
	1	1	2	2	3	4	4	5	6	6	7	8
	1	1	2	2	3	4	4	5	5	6	6	7

**Important notes:**

- Dimensions-** All dimensions shown in millimetres.
  - Door-** Door panels, track, soffit and bottom guide channel by WID.
  - Structure-** All other materials and work to be provided by others. ALL FIXING FACES MUST BE FLUSH AND IN THE SAME VERTICAL PLANE AND ARE INDICATED AS THUS
  - The lintel must be suitably tied into the structure to resist any over-turning movement and of adequate size to ensure the top track does not deflect more than 13mm under a moving load of 36.7kg per square meter of door area in the direction and position of the arrow shown in the sectional view.
  - Fixing-** Suitable masonry fixings to withstand load to be used. When steel section lintels are used 11mm dia holes must be drilled. Fixings supplied by WID.
- SCALE AND MEASURE INCLUDED ON SAMPLE AS REFERENCE.  
SUBJECT TO CHANGE BASED ON INSTALLATION AREA.